

BASE LINK TOILET SUITE

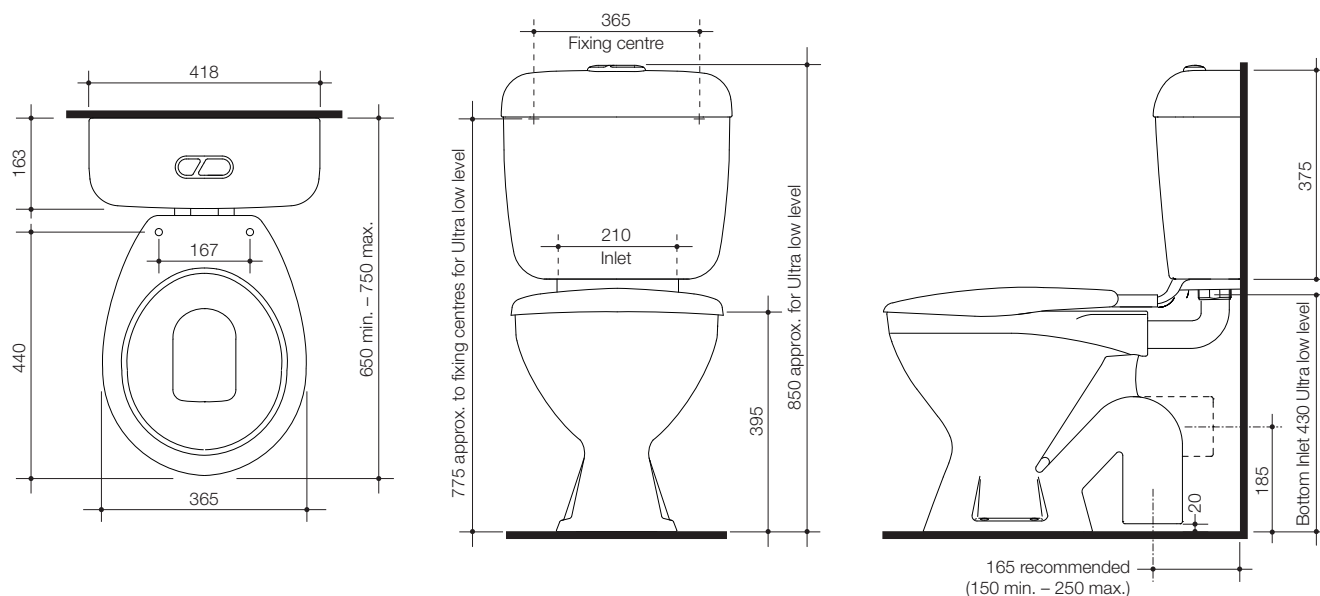

SPECIFICATIONS

| | |
|----------------------------|--|
| Recommended use | Domestic, hotel, commercial |
| Material | Vitreous china with plastic cistern |
| Water inlet | Let or right bottom inlet |
| Pan Trap | S or P trap available |
| Colour Availability | White |
| Capacity | 4.5/3L, adjustable to 6/3L or 9/4.5L |
| Standards | AS 1172 |
| WELS | 4 stars |
| | 4.5/3 litres per flush, average 3.5 litres per flush |

CLEANING RECOMMENDATIONS

We recommend the use of soapy water or approved cleaners. This product should not be cleaned with abrasive materials. Damage caused by any improper treatment is not covered by the product warranty - refer to Warranty Conditions on the last page.



To see the complete Base range go to www.reece.com.au/bathrooms

Disclaimer: Products in this specification manual must by regulation be installed by licensed and registered trade people. The manufacturer/distributor reserves the right to vary specifications or delete models from their range without prior notification. Dimensions and set-outs listed are correct at time of publication however the manufacturer/distributor takes no responsibility for printing errors.

Tech Page Version 2

base

reece

BASE LINK TOILET SUITE

INSTALLATION INSTRUCTIONS

PAN FIXING PROCEDURE

Rough-in Procedure

The soil pipe and pan collar should be accurately fixed into position, as detailed in Figure 1 and Figure 2.

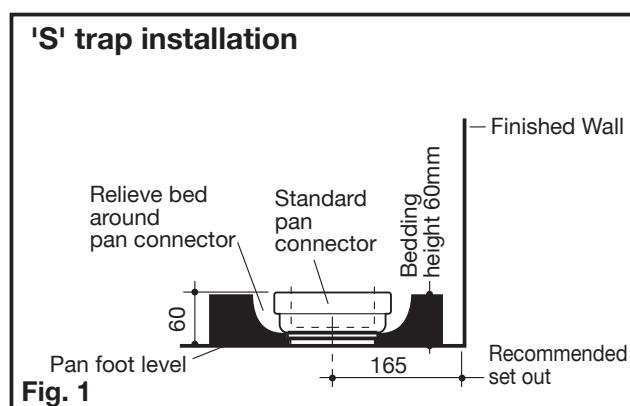

IMPORTANT: ALL DIMENSIONS ARE TO THE UNDERSIDE FOOT LEVEL OF THE PAN. IT IS IMPORTANT TO MAKE A HEIGHT ALLOWANCE FOR BEDDING.

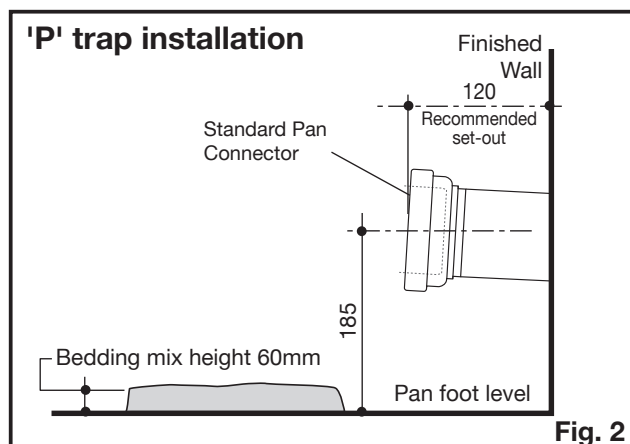

Pan Bedding:

- 1- Remove an area of tiles which are within the internal area covered by the foot of the pan to expose the subfloor to provide a bondage key for the bedding mixture.
- 2- Ensure that bedding area is clean and free of building material.
- 3- Prepare bedding sand cement mixture 3:1 to depth of 60mm as detailed in **Figure 1** or **Figure 2**.

NOTE: Do not fill the foot of the pan with bedding mix or include lime or fast drying cement in the mix, these may cause cracking in the foot of the pan.

- 4- Position pan and connect with pan connector then level pan into bedding mixture, so that the back of the foot of the pan is approximately 10mm above the finished floor as detailed in **Figure 3**. It is recommended that wedges are used to support the foot of the pan during the positioning.

SCREW FIXING:

- 1- Position pan onto pan connector. Adjust pan position if necessary and mark location of pan fixing holes on the floor. Remove the pan.
 - 2- Drill holes in the marked positions on the floor. The hole diameter is dependent on the type of fixing system and floor finish.
- IMPORTANT:** DO NOT USE THE PAN SCREW HOLES AS A GUIDE FOR DRILLING AS THIS MAY CRACK THE PAN.
- 3- Ensure that the area around the floor is clean and free from building material.
 - 4- Run a bead of acetic cured silicone sealant at a height of 8mm approximately fully around the foot of the pan which contacts the floor. Use wedges around the foot base (if required) so that the maximum height of silicone sealant is not greater than 5mm on completion on bedding.
 - 5- Connect pan to pan connector and fix to the floor with suitable corrosion resistant screws. Level the pan with the acetic cured silicone sealant to the finished floor. Remove any excess sealant.

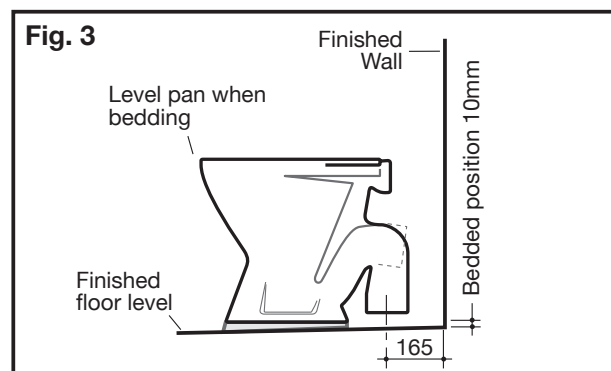

VITREOUS CHINA

Plumbers, please ensure a copy of the installation instructions is left with the end user for future reference

BASE LINK TOILET SUITE

INSTALLATION INSTRUCTIONS

- 1** Check that the pan is installed within dimensional tolerances. Mark out the fixing holes for the cistern on the wall making sure they are level.

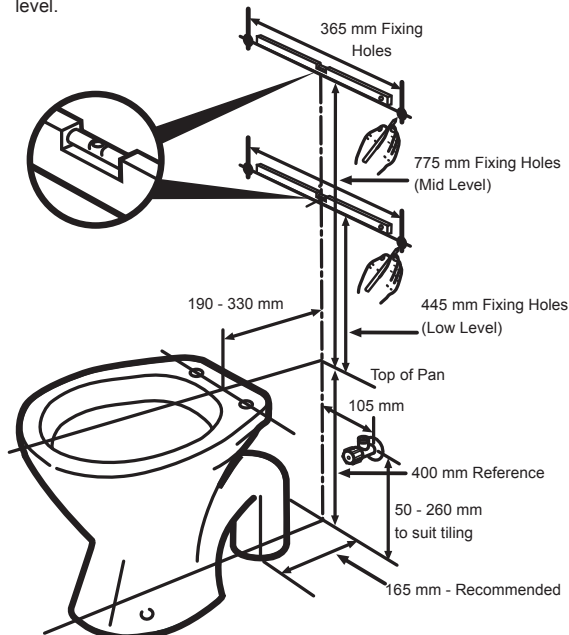

- 2** In masonry, drill 8mm diameter holes and insert the plugs provided. In timber, drill 3mm diameter pilot holes. Leave the screws protruding by 10mm.

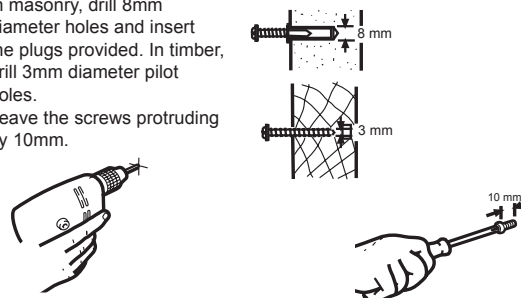

- 3** When installing low level use L-shaped pipe only. For mid level fit the seal and lubricate it with soap and water. Push firmly into the shorter leg of the flush pipe.

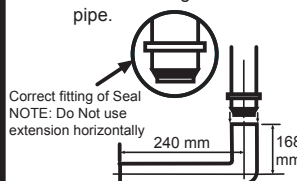

- 4** Cut the flushpipe to dimensions shown. Lubricate the kee seal with soap and water and fit the pipe.

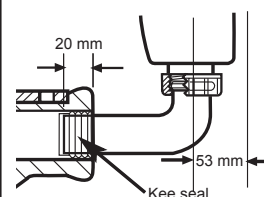

- 5** Lower the cistern onto the pipe and hook it over the mounting screws.

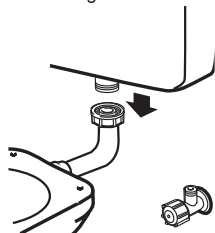

- 6** Hand tighten the nut.

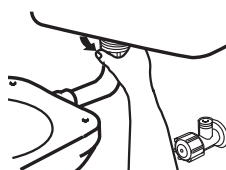

- 7** Nip up the mounting screws.

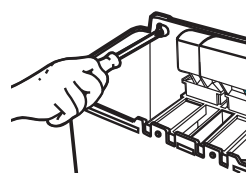

- 8** Flush the water supply line.

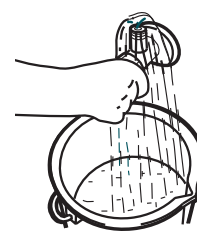

- 9** Make sure that the strainer is in place. Then fit the water supply pipe using approved fittings.

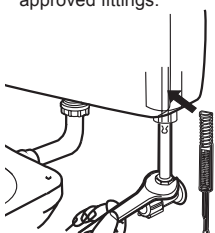

- 10** Turn on the water. Operate the cistern and check for leaks.

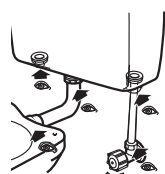

- 11** Actuate the Inlet valve at least once to purge any trapped air in the valve. Adjust the water level to the WL2 mark.

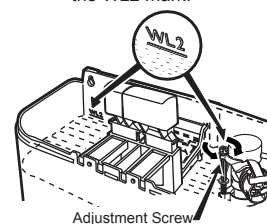

- 12** Carefully refit the lid.



BASE LINK TOILET SUITE



REECE PRODUCT QUALITY GUARANTEE

You have purchased a quality product from Reece Pty Ltd ABN 84 004 097 090 ("Reece"). This product is covered by a 1 year replacement product warranty and a 12 month warranty over spare parts and labour.

1 YEAR WARRANTY – DOMESTIC USE

This warranty covers faults in the product construction, material and assembly. Products which are within 1 year from the date of purchase, found upon inspection by an authorised Reece representative, to be defective in construction, material or assembly, will be repaired or exchanged with an equivalent product free of charge. Replaced items become Reece's property.

All replacement products will be available for collection without charge to the customer at the nearest Reece branch to the customer's location, or elsewhere as agreed between the customer and Reece.

Labour and Spare Parts

The labour for the replacement of products and spare parts to which this warranty applies will be supplied by Reece or relevant supplier using licensed plumbers engaged by Reece or relevant supplier within 1 year from the date of purchase.

Spare parts (includes the toilet seat) other which are within 1 year from the date of purchase found upon inspection by an authorised Reece representative to be defective in construction, material or assembly, will be replaced free of charge.

Warranty Conditions

This warranty will apply only under all of the following conditions:

- The item has been installed by a licensed plumber
- The item has been installed for and subjected to domestic residential use only
- Failure is due to a fault in the manufacture of the product
- Proof of purchase (including the date of purchase) is provided
- The installation of the product is in accordance with the instructions provided

This warranty does not cover products purchased as an ex-display without being fully checked and tested for sale by the manufacturer.

This warranty does not include faults caused by:

- Unsuitable or improper use
- Incorrect installation or installation not in accordance with the instructions provided
- Installation or part installation by the purchaser or any person other than a LICENSED PLUMBER
- Normal wear and tear
- Inadequate or complete lack of maintenance
- Chemical, electrochemical or electrical influences
- Harsh detergents or abrasive cleaners used on product finishes

1 YEAR WARRANTY – COMMERCIAL USE

'Commercial' use is all use other than for normal domestic residential purposes, including use in non-business places as in public buildings, schools, sports centres and in establishments that contain private bathrooms with high frequency of use by many individuals, such as hotels, motels, retirement villages and hospitals.

The Commercial warranty covers this product against manufacturing faults in the construction, material and assembly of both the finished products and any spare parts for a period of 1 year from the date of purchase. Products and spare parts which are found upon inspection by an authorised Reece representative to be defective in construction, material or assembly will be repaired or exchanged free of charge. Replaced items become Reece's property. The labour for the replacement of products and spare parts to which this warranty applies will be supplied by Reece or relevant supplier using licensed plumbers engaged by Reece or relevant supplier. The Warranty Conditions and exclusions which apply to the domestic use warranty also apply to this commercial warranty.

EXCLUSIONS

To the fullest extent permitted by law, Reece excludes all liability for damage or injury to any person, damage to any property, and any indirect consequential or other loss or damage.

CLAIM PROCEDURE

For all warranty queries customers are to contact the branch where the product was purchased. These details can be found on your purchase invoice.

Our goods come with guarantees that cannot be excluded under the Australian Consumer Law. You are entitled to a replacement or refund for a major failure and for compensation for any other reasonably foreseeable loss or damage. You are also entitled to have the goods repaired or replaced if the goods fail to be of acceptable quality and the failure does not amount to a major failure.